

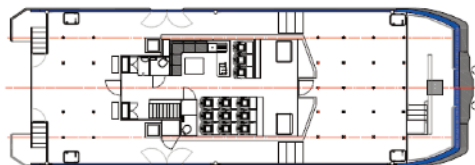

# ICENI VENTURE

## 22M CREW TRANSFER VESSEL



PROVEN PERFORMANCE

[www.icenimarine.co.uk](http://www.icenimarine.co.uk)



22M CREW TRANSFER VESSEL



LAUNCHED JANUARY 2015

## V E S S E L   S P E C I F I C A T I O N

Vessel name	Iceni Venture
Vessel hull	Southboats IOW
Build date	January 2015
Beam	8 metres
Classification	MCA Cat 2, Class DNV 1A1 HSLC R2 Windfarm service 1
Length	22.8 metres
Draft	1.5 metre
Flag	UK
Engines	2x MAN 12v 1400 1400 hp
Propulsion	2x Servogear HD295
Generator	1 x Cummins Onan 17.5 kw / 1 x Onan 6 kw
Gearbox	2x Servogear HD295
Transfer access system	No
Owner declared transfer	2 metres significant
Deck crane fitted	Yes
Deck crane	Palfinger PK4501M 900kg. 5.1m reach
Displacement	75,000 kg
Total fuel capacity	10,000 lts
Range	570 nm
Fuel transfer fitted	No
Fuel transfer system	N/A
Fuel	EN590
Crew	2-3
Passengers	12
Available seats (PAX)	12 airsprung KPM seats, 3 benches
Berths	2
Pressure washer fitted	Yes
Pressure washer specification	30LPM @ 150 bar
Sprint speed	30 knots
Service speed	25 knots
Fuel @ sprint	530 Lts per hr @ 100%
Fuel @ service	420 Lts per hr @ 85%
Fresh water capacity	700 Lts
Bollard Pull	14 Tonnes
Thrusters	2x bow 40hp 2x stern 40hp
Bow deck cargo	10,000 kg
Aft deck cargo	5,000 kg
Bow deck dimensions	60 m <sup>2</sup>
Aft deck dimensions	60 m <sup>2</sup>
Bow fendering	Seasight
Hydraulic system fitted	300 bar @ 60lts per minute



**ICENI**  
MARINE SERVICES

## ELECTRONICS FITTED

MAIN RADAR: Furuno 2117BB-6.5-24v Radar System  
6.5ft 12Kw Open Array  
MU190 Approved monitor  
SECOND RADAR: Furuno 2117BB-4-24v Radar System  
4ft 12Kw Open Array  
MU190 Approved monitor  
ECDIS Furuno ECDIS FEA2107 c/w MU190 Approved monitor  
SECOND CHART: Furuno MFD-BB Navnet 3D Chart/Sounder/CCTV System  
Furuno DFF1 Network Sounder  
CCTV Multiplexer  
CCTV DVR  
12 x CCTV Cameras  
1 x forward deck  
1 x port deck  
1 x stbd deck  
1 x aft deck  
1 x saloon  
1 x port engine room  
1 x stbd engine room  
1 x port jet space  
1 x stbd jet space  
1 x Flir thermal imaging / low light camera c/w pan and tilt  
NAVTEX: Furuno NX700B Navtex  
GPS: Furuno GP150 GPS  
ANEMOMETER: Furuno RD33 c/w Maretron Wind Speed  
SPEED LOG: Walker 7070 Electromagnetic Speed Log  
AUTOPILOT: Navitron NT888G approved auto-pilot  
DSC VHF: 2 x Sailor RT6222 Class A DSC VHF  
4 x 1.2m Comrod Antennae  
MF/HF A2: Sailor RT5000 MF/HF SSB Radio Telephone  
8m Comrod Transmit Antenna  
6m Comrod Receive Antenna  
AIS: Furuno FA150 Class A AIS Transceiver  
GPS Antenna  
1.2m Comrod Antenna  
HEADING: Furuno SC50 Satellite Compass  
CELL PHONE: Nokia Phone (client to supply SIM card)  
TH Bury Hands Free Kit c/w Antenna Coupler  
1.2m Comrod Antenna  
BROADBAND: Globesurfer III c/w Wireless Router  
Requires client SIM Data Card and Access Point Code  
SATCOM: KVH Tracphone V3 with Mini VSAT Broadband Service  
Tracphone V3 Antenna Unit  
Tracphone V3 Control Unit & Modem  
1 x Telephone Handsets  
Iceni Marine Services Ltd.  
1 x Data Access Point to Aft Wheelhouse  
GMDSS Equipment: 2 x Jotron SART20 TRON Sart  
1 x Jotron TRON 40GPS/FB5 EPIRB  
3 x Jotron TRON VHF Hand Held VHF Radios  
RESCUE: Seamarshall SAR Finder  
121.5Mhz for EPIRB/SART/PLB homing  
Complete with antenna and display, 3 x PLB's & Test Unit  
TALKBACK/HAILER: PHONTECH 3100 System  
FWD deck Talk back  
Port Side Rescue Zone Area Talkback  
Stbd Side Rescue Zone Area Talkback  
Passenger Saloon Talkback  
Passenger Area Speakers Duplicated  
Line Amplifiers in both Passenger Loops  
RADIO CHARGING: Victron 30A GMDSS Monitoring & Alarm Panel  
Split Charger, 10A to Charge Reserve Battery  
GMDSS battery bank  
SATELLITE TV: KVH Tracvision M3DX  
PIES: 1 x Marine DVD player/FM radio system  
2 x Marine speakers (pairs)  
1 x Comrod AV51 FM antenna  
2 x 22" FWD TVs  
1 x 26" TV/DVD at Galley  
2 x 19" TV/DVD in Crew Accommodation



**ICENI**  
MARINE SERVICES

## LIFESAVING EQUIPMENT FITTED

4 x Cosalt Surviva A 8 Man Liferrafts  
2 x Thermal Protective Aids  
4 x Hammar Hydrostatic Release  
4 x Spencer Rigging Liferaft Lashing Strap  
4 x 4kg 30" Perrybuoy c/w Reflective Tape  
2 x L90 Lifebuoy Lights  
1 x KIM Lifebuoy Drouge & Pocket  
2 x 18 Metres Orange Floating Line 8mm c/w Canvas Storage Bags  
17 x Premier L/J 2010 Adult + Dan c/w Light Lifevests  
15 x Cosalt Immersion Suits  
2 x KIM Cruising Adult Harness c/w Attached Line  
12 x Red Parachute Rocket  
6 x Red Hand Held Flare  
2 x Lifesmoke Mk8  
1 x OS Yellow Poly Bottle 2 Ltr  
1 x VHF GMDSS Safety Message Card  
2 x SOLAS No. 2 Card  
1 x Code of Practice Training Manual  
1 x SOLAS Training Manual  
2 x 3 Gallon Red Fire Bucket  
1 x Fire Blanket Slim Pack MSA  
3 x Anchor Ball  
1 x Triangle  
1 x Prism (barrel)  
1 x Echomax EM230 Radar Reflector White  
1 x KIM Galley strop  
1 x Code of Practice F/A Kit (Boxed) 1998  
1 x Jason's Cradle Scamble Net  
1 x Portable Search Light  
1 x Ships Bell (Approved for purpose)  
2 x 5 Kg CO2 Fire Extinguisher  
2 x 6kg Powder Extinguisher  
2 x 6kg foam Extinguisher  
1 x Signal Torch  
Emergency Signage (shall as a minimum include, could be more depending on class/flag)  
2 x Life Buoy with Light  
2 x Life Buoy with Line  
15 x Lifejacket  
3 x Immersion suits (quantity depend on number of storage locations)  
3 x Survival craft Radio  
2 x Epirb  
2 x Radar Transponder (SART)  
1 x Pyrothecnic  
1 x Muster Station  
1 x Stretcher  
1 x First Aid  
18 x Emergency Escape (Arrow and Sign)  
6 x Fire Extinguisher Signs (2 Co2, 2 Powder, 2 Foam)

Iceni Marine Services Ltd  
2 Battery Green Road  
Lowestoft Suffolk NR32 1DH

T +44 (0)1502 290030

E [info@icenimarine.co.uk](mailto:info@icenimarine.co.uk)

**PROVEN PERFORMANCE**

[www.icenimarine.co.uk](http://www.icenimarine.co.uk)