

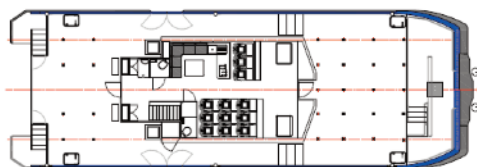

ICENI DEFENDER

22M CREW TRANSFER VESSEL



PROVEN PERFORMANCE

www.icenimarine.co.uk



22M CREW TRANSFER VESSEL

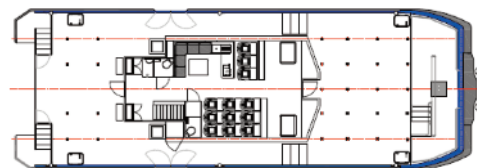

LAUNCH DATE JANUARY 2017

V E S S E L S P E C I F I C A T I O N

Vessel name	Iceni Defender
Vessel hull	Southboats IOW
Build date	January 2017
Beam	8 metres
Classification	MCA Cat 2, Class DNV 1A1 HSLC R2 Windfarm service 1
Length	22.8 metres
Draft	1.5 metre
Flag	UK
Engines	2x MAN 12v 1400 1400 hp
Propulsion	2x Hamilton jet HM571
Generator	1 x Cummins Onan 17.5 kw / 1 x Onan 6 kw
Gearbox	2x ZF 3050 series5
Transfer access system	No
Owner declared transfer	2 metres significant
Deck crane fitted	Yes
Deck crane	Palfinger PK4501M 900kg. 5.1m reach
Displacement	75,000 kg
Total fuel capacity	10,000 lts
Range	550 nm
Fuel transfer fitted	No
Fuel transfer system	N/A
Fuel	EN590
Crew	2-3
Passengers	12
Available seats (PAX)	12 airsprung KPM seats, 3 benches
Pressure washer fitted	Yes
Pressure washer specification	30LPM @ 150 bar
Sprint speed	30 knots
Service speed	25 knots
Fuel @ sprint	540 Lts per hr @ 100%
Fuel @ service	430 Lts per hr @ 85%
Fresh water capacity	700 Lts
Bollard Pull	12 Tonnes
Thrusters	No
Bow deck cargo	10,000 kg
Aft deck cargo	5,000 kg
Bow deck dimensions	60 m ²
Aft deck dimensions	60 m ²
Bow fendering	Seasight
Hydraulic system fitted	300 bar @ 60lts per minute



ICENI
MARINE SERVICES

ELECTRONICS FITTED

MAIN RADAR: Furuno 2117BB-6.5-24v Radar System
6.5ft 12Kw Open Array
MU190 Approved monitor
SECOND RADAR: Furuno 2117BB-4-24v Radar System
4ft 12Kw Open Array
MU190 Approved monitor
ECDIS Furuno ECDIS FEA2107 c/w MU190 Approved monitor
SECOND CHART: Furuno MFD-BB Navnet 3D Chart/Sounder/CCTV System
Furuno DFF1 Network Sounder
CCTV Multiplexer
CCTV DVR
12 x CCTV Cameras
1 x forward deck
1 x port deck
1 x stbd deck
1 x aft deck
1 x saloon
1 x port engine room
1 x stbd engine room
1 x port jet space
1 x stbd jet space
1 x Flir thermal imaging / low light camera c/w pan and tilt
NAVTEX: Furuno NX700B Navtex
GPS: Furuno GP150 GPS
ANEMOMETER: Furuno RD33 c/w Maretron Wind Speed
SPEED LOG: Walker 7070 Electromagnetic Speed Log
AUTOPILOT: Navitron NT888G approved auto-pilot
DSC VHF: 2 x Sailor RT6222 Class A DSC VHF
4 x 1.2m Comrod Antennae
MF/HF A2: Sailor RT5000 MF/HF SSB Radio Telephone
8m Comrod Transmit Antenna
6m Comrod Receive Antenna
AIS: Furuno FA150 Class A AIS Transceiver
GPS Antenna
1.2m Comrod Antenna
HEADING: Furuno SC50 Satellite Compass
CELL PHONE: Nokia Phone (client to supply SIM card)
TH Bury Hands Free Kit c/w Antenna Coupler
1.2m Comrod Antenna
BROADBAND: Globesurfer III c/w Wireless Router
Requires client SIM Data Card and Access Point Code
SATCOM: KVH Tracphone V3 with Mini VSAT Broadband Service
Tracphone V3 Antenna Unit
Tracphone V3 Control Unit & Modem
1 x Telephone Handsets
Iceni Marine Services Ltd.
1 x Data Access Point to Aft Wheelhouse
GMDSS Equipment: 2 x Jotron SART20 TRON Sart
1 x Jotron TRON 40GPS/FB5 EPIRB
3 x Jotron TRON VHF Hand Held VHF Radios
RESCUE: Seamarshall SAR Finder
121.5Mhz for EPIRB/SART/PLB homing
Complete with antenna and display, 3 x PLB's & Test Unit
TALKBACK/HAILER: PHONTECH 3100 System
FWD deck Talk back
Port Side Rescue Zone Area Talkback
Stbd Side Rescue Zone Area Talkback
Passenger Saloon Talkback
Passenger Area Speakers Duplicated
Line Amplifiers in both Passenger Loops
RADIO CHARGING: Victron 30A GMDSS Monitoring & Alarm Panel
Split Charger, 10A to Charge Reserve Battery
GMDSS battery bank
SATELLITE TV: KVH Tracvision M3DX
PIES: 1 x Marine DVD player/FM radio system
2 x Marine speakers (pairs)
1 x Comrod AV51 FM antenna
2 x 22" FWD TVs
1 x 26" TV/DVD at Galley
2 x 19" TVDVD in Crew Accommodation



ICENI
MARINE SERVICES

LIFESAVING EQUIPMENT FITTED

4 x Cosalt Surviva A 8 Man Liferrafts
2 x Thermal Protective Aids
4 x Hammar Hydrostatic Release
4 x Spencer Rigging Liferaft Lashing Strap
4 x 4kg 30" Perrybuoy c/w Reflective Tape
2 x L90 Lifebuoy Lights
1 x KIM Lifebuoy Drouge & Pocket
2 x 18 Metres Orange Floating Line 8mm c/w Canvas Storage Bags
17 x Premier L/J 2010 Adult + Dan c/w Light Lifevests
15 x Cosalt Immersion Suits
2 x KIM Cruising Adult Harness c/w Attached Line
12 x Red Parachute Rocket
6 x Red Hand Held Flare
2 x Lifesmoke Mk8
1 x OS Yellow Poly Bottle 2 Ltr
1 x VHF GMDSS Safety Message Card
2 x SOLAS No. 2 Card
1 x Code of Practice Training Manual
1 x SOLAS Training Manual
2 x 3 Gallon Red Fire Bucket
1 x Fire Blanket Slim Pack MSA
3 x Anchor Ball
1 x Triangle
1 x Prism (barrel)
1 x Echomax EM230 Radar Reflector White
1 x KIM Galley strop
1 x Code of Practice F/A Kit (Boxed) 1998
1 x Jason's Cradle Scamble Net
1 x Portable Search Light
1 x Ships Bell (Approved for purpose)
2 x 5 Kg CO2 Fire Extinguisher
2 x 6kg Powder Extinguisher
2 x 6kg foam Extinguisher
1 x Signal Torch
Emergency Signage (shall as a minimum include, could be more depending on class/flag)
2 x Life Buoy with Light
2 x Life Buoy with Line
15 x Lifejacket
3 x Immersion suits (quantity depend on number of storage locations)
3 x Survival craft Radio
2 x Epirb
2 x Radar Transponder (SART)
1 x Pyrothecnic
1 x Muster Station
1 x Stretcher
1 x First Aid
18 x Emergency Escape (Arrow and Sign)
6 x Fire Extinguisher Signs (2 Co2, 2 Powder, 2 Foam)

Iceni Marine Services Ltd
2 Battery Green Road
Lowestoft Suffolk NR32 1DH

T +44 (0)1502 290030

E info@icenimarine.co.uk

PROVEN PERFORMANCE

www.icenimarine.co.uk